

FILENAME: 56-17034-M102A.DWG SOURCE: W. & S. CITY OF LEDUC 56-17034-2018 CAPITAL WORKS - NORTH TELFORD NEIGHBOURHOOD RENEWAL DESIGN PROCESS & LAYOUT & S. WORKING DRAWINGS  
 DRAWN BY: SRAVET PLOT DATE: APR 27, 2018

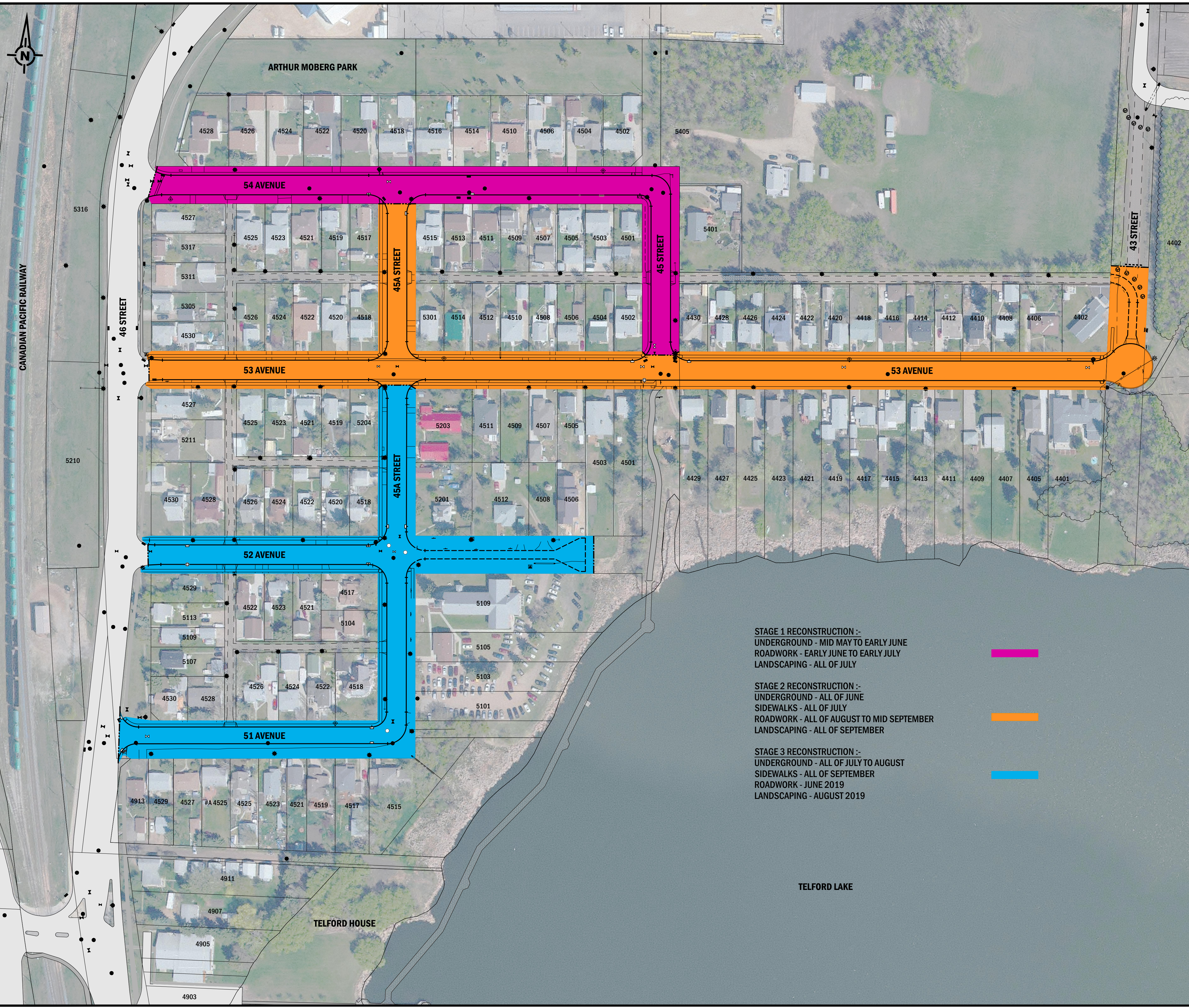

**STAGE 1 RECONSTRUCTION :-**  
 UNDERGROUND - MID MAY TO EARLY JUNE  
 ROADWORK - EARLY JUNE TO EARLY JULY  
 LANDSCAPING - ALL OF JULY

**STAGE 2 RECONSTRUCTION :-**  
 UNDERGROUND - ALL OF JUNE  
 SIDEWALKS - ALL OF JULY  
 ROADWORK - ALL OF AUGUST TO MID SEPTEMBER  
 LANDSCAPING - ALL OF SEPTEMBER

**STAGE 3 RECONSTRUCTION :-**  
 UNDERGROUND - ALL OF JULY TO AUGUST  
 SIDEWALKS - ALL OF SEPTEMBER  
 ROADWORK - JUNE 2019  
 LANDSCAPING - AUGUST 2019

**GENERAL NOTES**

1. ALL DIMENSIONS ARE IN METRES UNLESS NOTED OTHERWISE.
2. ALL EXISTING UTILITY LOCATIONS MAY NOT BE SHOWN. ANY EXISTING UTILITIES THAT ARE SHOWN ARE APPROXIMATE. THE CONTRACTOR IS RESPONSIBLE FOR THE VERIFICATION OF LOCATION AND PROTECTION OF ALL EXISTING UTILITIES, WHETHER SHOWN ON THE DRAWINGS OR NOT.
3. CONTACT ALBERTA ONE-CALL AT 1-800-242-3447 PRIOR TO ANY CONSTRUCTION.
4. CONTACT DIG SHAW AT 1-866-344-7429 PRIOR TO ANY CONSTRUCTION.
5. CONTACT THE CITY OF LEDUC PUBLIC WORKS DEPARTMENT PRIOR TO ANY EXPOSURE AND CONNECTION TO EXISTING INFRASTRUCTURE.
6. THE CONTRACTOR IS RESPONSIBLE TO NOTIFY ANY PARTY REQUIRING A CROSSING AGREEMENT AND TO RESPECT ALL CROSSING AGREEMENT REQUIREMENTS.
7. THE CONTRACTOR IS RESPONSIBLE FOR PROVIDING ADEQUATE NOTICE TO ANY AFFECTED PRIVATE OR PUBLIC SECTOR REGARDING MUNICIPAL SERVICE AND/OR ACCESS DISRUPTIONS.
8. ALL DISTURBED AREAS ARE TO BE REPAIRED, REPLACED AND/OR LANDSCAPED TO NEW CONDITION. CONCRETE OR ASPHALT REPAIRS SHALL BE CUT AND SQUARED TO THE SATISFACTION OF THE RESIDENT ENGINEER. LANDSCAPED REPAIRS ARE TO BE TOPSOILED AND SEEDED TO A MINIMUM DEPTH OF 75mm AND MAINTAIN POSITIVE DRAINAGE.

**LEGEND**

	PROPOSED	EXISTING
CURB & GUTTER		
SIDEWALK		
MANHOLE (MH)		
CATCHBASIN MANHOLE (CBMH)		
CATCHBASIN AND LEAD (CB)		
WATER VALVE (VAL)		
FIRE HYDRANT (HYD)		
POWER POLE		
LIGHT STANDARD		
PEDESTAL		
TRAFFIC SIGN		
CULVERT		
TREE		
TREE DRIPLINE		
EXISTING ROAD		
GRAVEL		
CONSTRUCTION / STAGE LIMIT		
CIVIC LOT ADDRESS		66

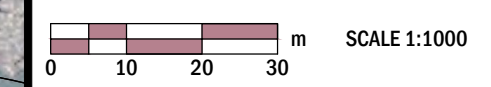

0	18	04	26	ISSUED FOR INFORMATION						
REV	Y	M	D	REVISION DESCRIPTION	DRN	SUPV	DES	CHK	ENG	APP

PERMIT	ENGINEER
--------	----------



**CITY OF LEDUC**  
**2018-01-001 - NORTH TELFORD NEIGHBOURHOOD RENEWAL**

**OVERALL PLAN**  
**NORTH TELFORD NEIGHBOURHOOD STAGING PLAN**

**56-17034-M102A**